

- 1. ALL DIMENSIONS ARE IN mm WITH  $\pm 0.20$  TOLERANCE UNLESS OTHERWISE SPECIFIED.
- 2. VIEWING ANGLE: 12:00 O'CLOCK.
- 3. VIEWING MODE: POSITIVE, REFLECTIVE
- 4. DISPLAY TYPE : TN
- 5. CONNECTOR: PIN
- 6. FLUID SPECIFICATION:
- DRIVING VOLTAGE: 3.0V
- MULTIPLY LEVEL: 1/4DUTY, 1/3BIAS
- OPERATING TEMP. :  $-5^{\circ}\text{C}$  --  $+55^{\circ}\text{C}$
- STORAGE TEMP. :  $-10^{\circ}\text{C}$  --  $+60^{\circ}\text{C}$

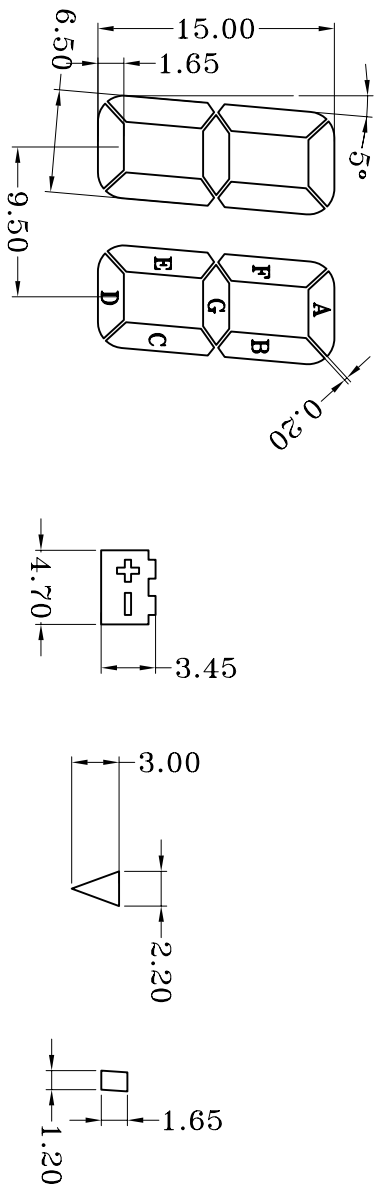

厦门精显电子有限公司  
XIAMEN PRECISE DISPLAY CO., LTD.

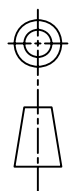

客户确认:		绘图: 谢博	绘图编号: GYTN2490P	单位: mm
审核: 吴永霞	批准: 汪地	客户编号: GD-535AP	日期: 2006.03.11	页数: 1/3